



HARD FOLDING TONNEAU COVER INSTALLATION GUIDE

3441EB APR/2012	GUIDE FOR FOLD-A-COVER®: GM4821, GM4822, GM4824	TRUCK MODEL(S): 2007-up CHEVY SILVERADO (new body style) 2007-up GMC SIERRA (new body style)
---------------------------	-----------------------------------------------------------	---------------------------------------------------------------------------------------------------------------



Truck model shown in image may or may not represent the truck referred to in this installation guide.

NOTES TO INSTALLER:

- Install Parts as shown in illustrations.
- Temperature should be no lower than 70°F when installing.
- Be sure the truck is setting on a level surface.
- Apply lock tight to each fastener during installation.
- **Some trimming of bed liner may be required for proper fit and function of cover.**
- Make sure the end user receives the warranty registration envelope, keys, and the operation instructions.

NOTES TO CUSTOMER:

For proper use and maintenance, refer to the operation and care label located under the rearmost panel of the cover on the driver's side.

Fold-a-Cover® is a product of Steffens Automotive
4045 Karona Court, Caledonia, MI 49316
phone: (616) 656.6886 fax: (616) 656.3771
www.steffensautomotive.com



HARD FOLDING TONNEAU COVER INSTALLATION GUIDE

STEP ONE: WINDSEAL APPLICATION

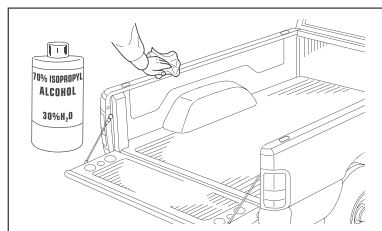

WIPE DOWN BOTH SIDE RAILS

Using a clean cloth and 70% Isopropyl Alcohol, wipe down both side rails to ensure a clean surface for installation.



REMOVE PROTECTIVE BACKER

Remove the protective film from the foam tape on the passenger and driver side windseal rails (B, C).

NOTE: The foam tape is for surface protection and moisture sealing on this application and is not adhesive.

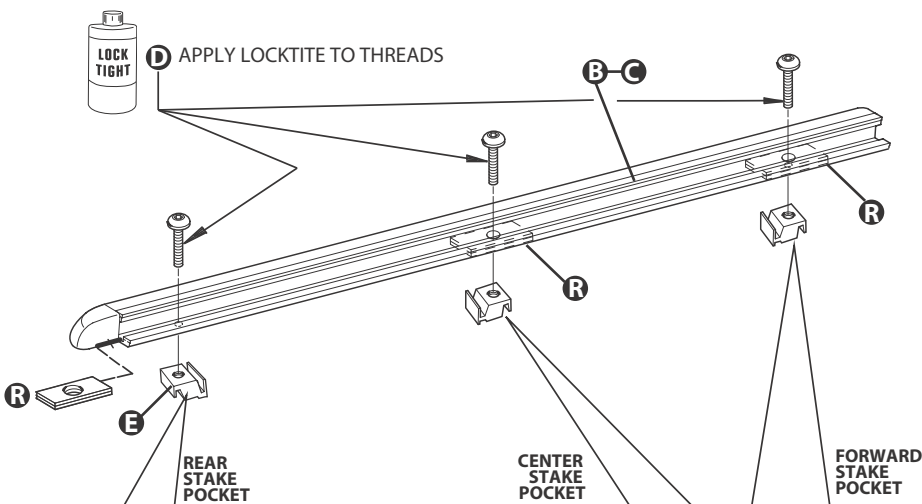

Insert the support washers (R) into the wind seal rails as pictured above.



Insert the 1/4" socket head bolts (D) through the support washer and through the slotted hole in the windseal rail.

NOTE: Use your thumb to hold the upper & lower rubber seals out of the way as you insert the bolt through the spacer and the wind seal rail.



Thread the stake pocket nuts (E) onto the bolts and rotate it approximately five turns.

NOTE: The deep groove in the stake pocket nut should face up toward the bottom of the windseal rail as shown in the illustrations.

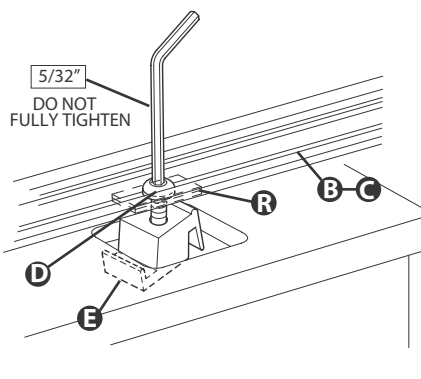
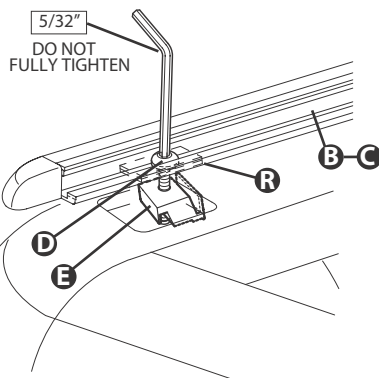

NOTE: 5' 8" and 6' 6" boxes have 2 stake pockets per side. 8' boxes have 3 stake pockets per side.



SECURE WINDSEAL RAIL TO VEHICLE

Align the completed wind seal rail assembly on the top of the box (see diagram above and picture to left) allowing the stake pocket bolts and nuts to drop into their respective stake pockets. Starting at the forward stake pocket on the driver's side of the vehicle make sure the stake pocket nut engages the stake pocket lip and hold a slight upward pressure on the rail.

Using a 5/32" allen wrench tighten the socket head bolt until the rail draws down and makes slight contact with the top of the box; only finger tight. Repeat these steps until all of the the stake pocket nuts are finger tight. on both the drivers and passenger side wind seal rails.

HARD FOLDING TONNEAU COVER INSTALLATION GUIDE

STEP TWO: TAILGATE LATCH INSTALLATION

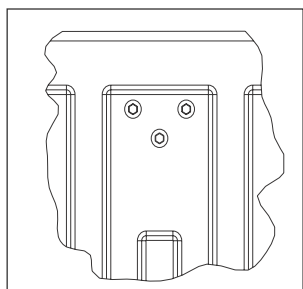

LOCATE TAILGATE BOLTS:
Locate top two tailgate bolts on inside center of the tailgate.

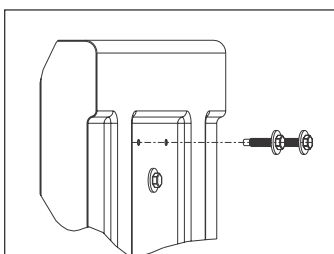

REMOVE TAILGATE BOLTS:
Remove and discard top two bolts.
NOTE: Do not remove lower bolt.

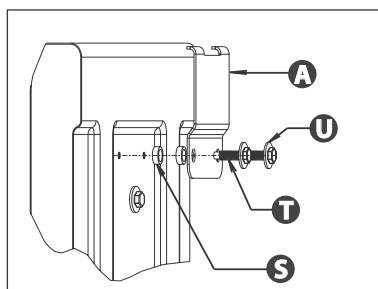

INSTALL TAILGATE LATCH BRACKET:
Install components as shown. Be sure to apply Loctite to bolt threads.

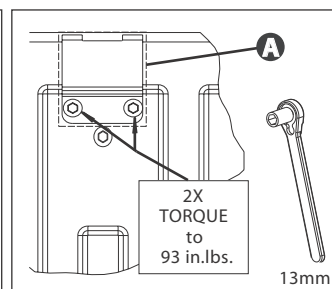

FASTEN BOLTS AT 93 in. lbs.:
If Latch Bracket (A) does not sit flat against tailgate, some trimming of the tailgate liner may be necessary.

STEP THREE: INITIAL COVER PLACEMENT

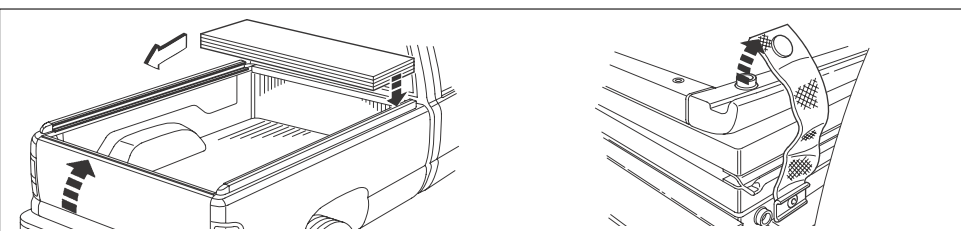

Carefully remove the folded cover from the shipping box and remove the packing materials from the corners of the cover. Place the cover between the windseal rails and release the snap restraints as shown in the images above.

NOTE: Assistance may be required to perform this step.



NOTE: Retain two of the foam corners for a later step.

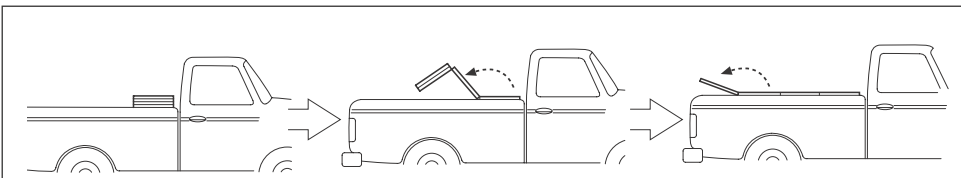

Unfold the cover between the windseal rails on the truck bed. It may be necessary to adjust the windseal rails for the cover to fold out flat and sit between the windseal rails. It may be necessary to adjust the position of the windseals to allow the cover to sit properly.

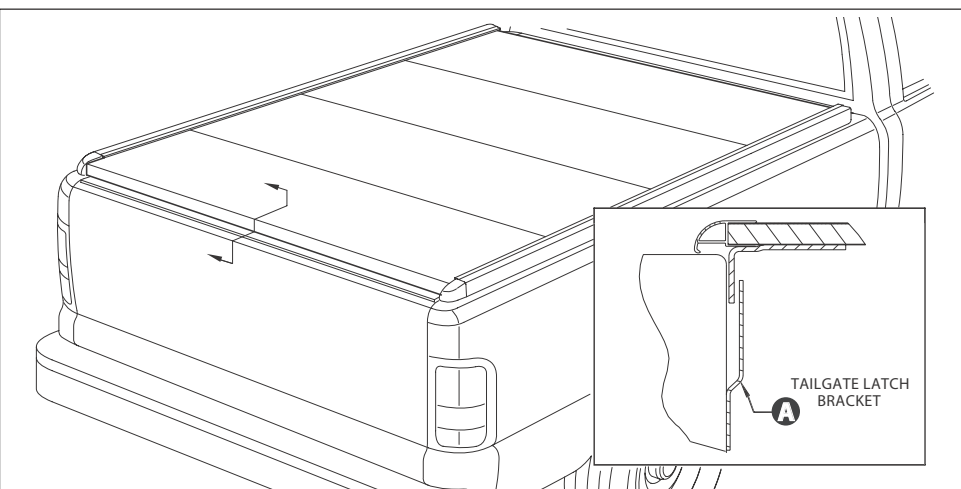

ADJUST PLACEMENT OF COVER:
Adjust the front to rear placement of the cover. Make sure the tailgate catch tab on the cover is engaging the tailgate latch bracket (A) that was bolted to the tailgate in step one. See the cross section view above. Open and close the rear panel to make sure there is no interference with the tailgate or the tailgate latch bracket.

CENTER the cover EVENLY & SQUARELY from side to side on the truck bed.



ALIGN LH & RH WINDSEAL RAILS TO COVER:
Make sure the upper rubber seal of the windseal rails are evenly spaced 1/32" to 1/16" from the top edge of the cover for the entire length of the cover, front to back on both sides. Also align the rear of the windseal rails with the rear panel of the cover on both sides.

STEP FOUR: SECURE COVER TO TRUCK BED

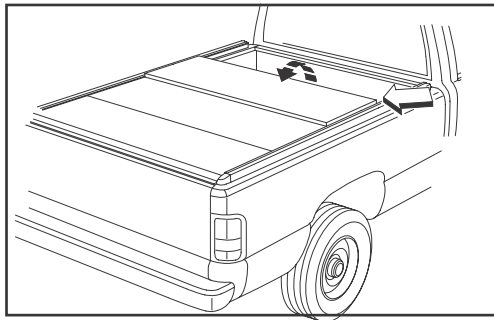

FOLD BACK FRONT PANEL

Carefully fold back the front panel, located directly behind the cab.

NOTE: Make sure cover does not move from its centered position on the truck bed.

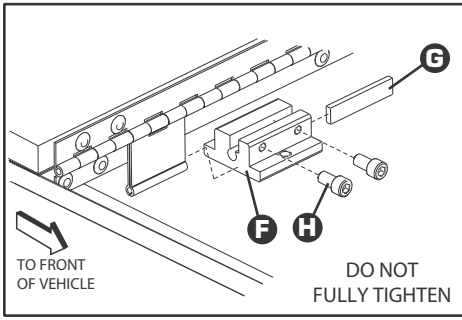

ASSEMBLE HINGE BRACKET

Assemble driver side and passenger side brackets (F, G, H) finger tight as shown in the diagram and picture above.

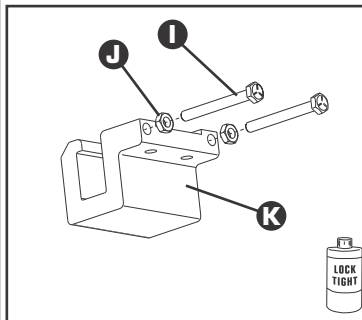

PREPARE C-CLAMP ASSEMBLY

Assemble driver side and passenger side C-clamp units (I, J, K). Thread the jam nut (J) all the way onto bolt (I) and thread them into C-clamp (K) as shown in diagram above.

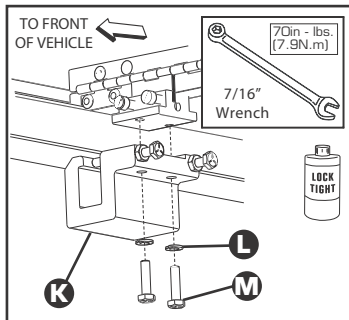

INSTALL C-CLAMP ASSEMBLY

Using bolts (M) attach the C-clamp units to the hinge brackets and tighten the bolts to 70 in. lbs. (7.9 N. m.).

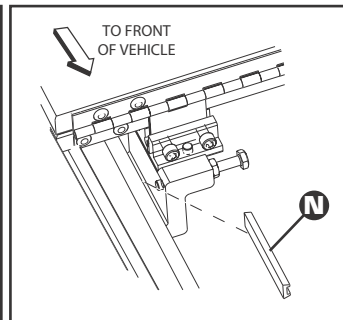

INSERT C-CLAMP SHIM

Insert the C-clamp shims (N) as shown in the diagrams above and thread the C-clamp bolts finger tight until the bolt contacts the center groove in the shim.

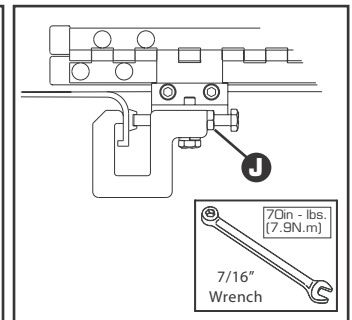

TIGHTEN BOLTS AND JAM NUTS

Make sure both C-clamp bolts contact the shim. The C-clamp assembly and shim should be parallel with the top of the truck bed. Avoid downward pressure on the C-clamp assembly as it is tightened. Check shim alignment and tighten the bolts to 70 in. lbs. (7.9 N. m). Tighten the jam nuts (J).

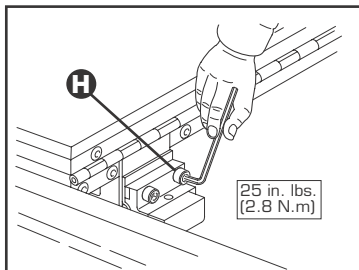

SECURE HINGE BRACKET BOLTS

Tighten hinge bracket set bolts to 25 in. lbs. (2.8 N. m.).

Note: Make sure hinge bracket shim (G) is seated to the bottom of the receiver groove in the hinge bracket.

STEP FIVE: INSTALL CATCH POSTS

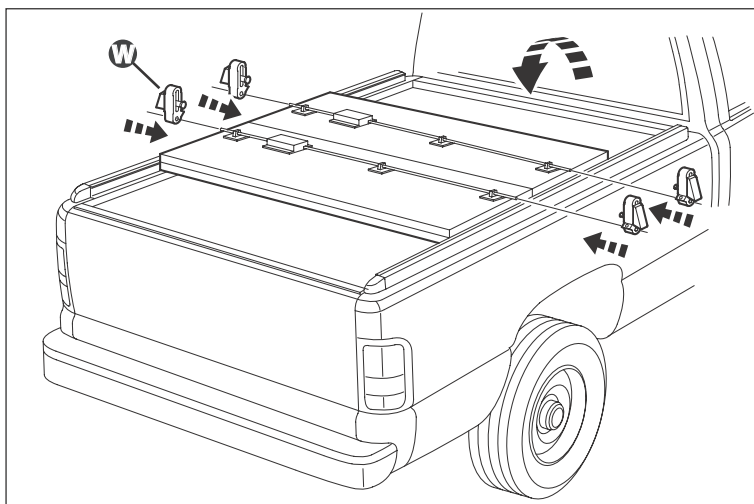

5/64"
Ball End
Allen Wrench

With the front & rear panels still in their fully open positions, install the Catch Post (W) to the ends of the rods on the end panels. Position the catch so body is away from the panel as shown in picture above. Slip the hole over the hex rod until flush. Use 5/64" allen wrench to tighten.

STEP SIX: INSTALL CATCH POCKETS

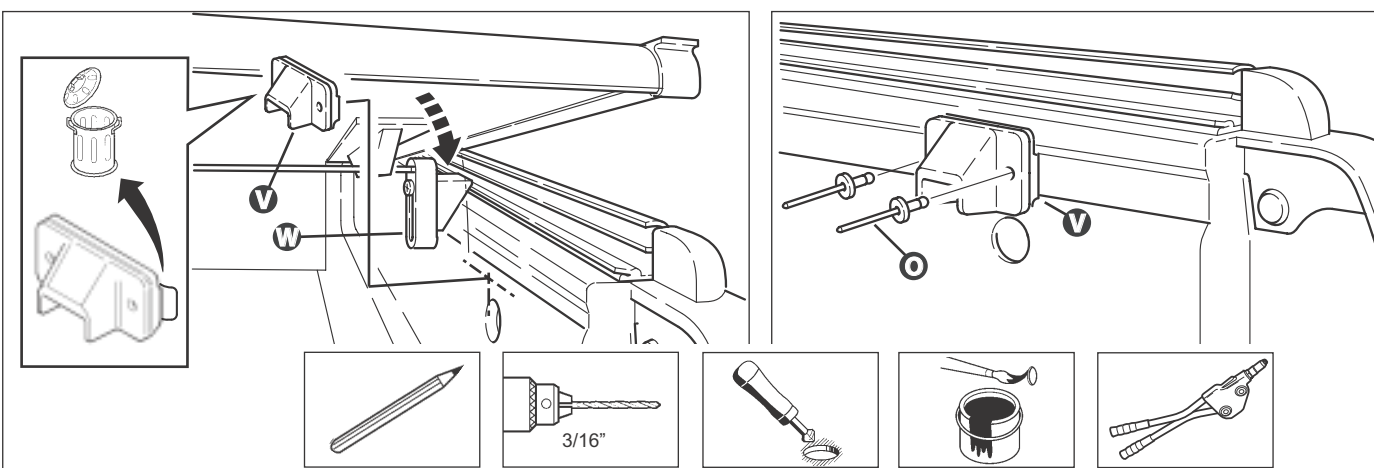

INSTALL REAR CATCH POCKETS

Gently lower the back panel to the closed position. Without removing the adhesive backing, position the Catch Pocket (V) so the Catch Post (W) fits within the pocket. Raise the Catch Pocket up until snug against the sheetmetal seam as shown above. Mark the location the two top holes of the Catch Pocket and remove and set aside.

Raise the panel into its open position. Use a 3/16" drill bit to create rivet holes for permanent fastening of the Catch Pocket. Carefully drill through the two marked positions for the holes from the Catch Pocket. Before inserting the rivets, clean the holes to remove burrs and sharp edges and apply touch-up paint to protect the exposed surface from the environment.

Retrieve the Catch Pocket and remove the adhesive backing. Replace the Catch Pocket so that the holes properly align and press firmly to make good contact with the surface. Insert the Rivets (O) and secure. Lower the rear panel and make adjustments as needed.

REPEAT PROCESS TO INSTALL FRONT CATCH POCKETS

STEP SEVEN: ADJUST LATCHES

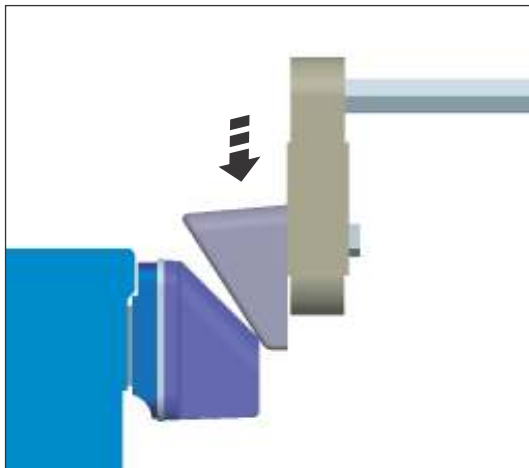

The Catch Post should touch the Catch as shown in the picture above when the panel is being closed.

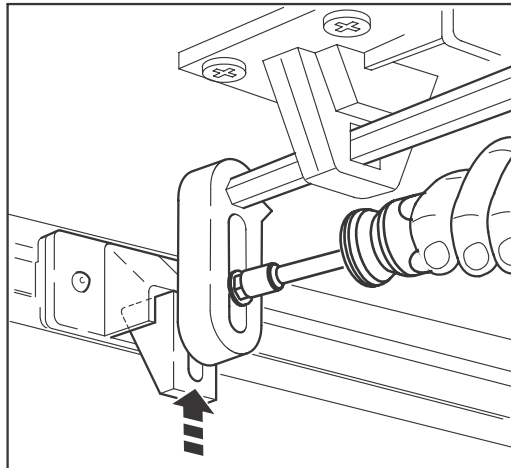

The Catch Post should latch inside the Catch Pocket as shown in the picture above when the panel is completely closed. Contact should only be on the bottom and not the side surfaces. If the Catch Post does not touch the bottom of the Catch Pocket, use a 5/16" socket to adjust the vertical position of the Catch Post so it does touch.

STEP EIGHT: ADJUST WINDSEALS



Close the tailgate of the truck and return the cover to its fully closed position on both ends of the front and rear panels. Recheck the spacing and alignment of the windseal rails with the cover.



Open the front and rear panel to expose the windseal rail bolts and using the 5/32" allen wrench, tighten the windseal rail to 70 in.lbs. (7.9 N.m.)



Return the cover to the closed position to make the vertical adjustment of the catch. use the 5/16" wrench to adjust the catch height as shown in the picture above.



With the front and rear panels in their closed positions, the top of the cover should be flush with the top of the windseal rails. Adjust the catch post & rod end assembly if needed. Tighten the four catches to 70 in.lbs. (7.9 N.m.)



To close and latch the front or rear panels, simply use a smooth, firm, downward pressure on the panel. Start the downward closing motion approximately 12 inches before the panel reaches its closed position.



Note: The catch post & rod end assembly may require readjustment after the seals are installed in a later step.

STEP NINE:

APPLY BULB SEALS TO COVER PANELS

SURFACE TEMP
70°F
OR ABOVE

Surface temperatures below 70 degrees F will adversely effect the bond strength of the seal adhesive.

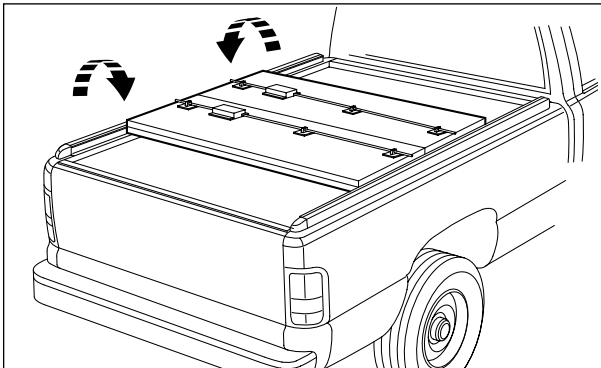

OPEN COVER TO EXPOSE SEAL LOCATIONS

Place two of the foam corner packing blocks from the packaging on the cover. Open the front and rear panels so they rest on these foam blocks.



CLEAN PANEL CONTACT SURFACE

For proper adhesion of the bulb seal it is important to clean the seal mating surfaces with either isopropyl or denatured alcohol before applying the adhesion promoter.



APPLY ADHESION PROMOTER

Open the adhesion promoter packet provided in your hardware kit and apply it to the contact surface with a thin, even layer. Too much promoter will reduce the adhesion strength.

Allow it to dry thoroughly before attaching the blade seal.



INSTALLATION OF NEW BULB SEAL(S)

FRONT: The front seal should be inset 1/2 inch off each end.

REAR: Rear seal should cover the entire width of the rear panel.

Remove a small section of the red backing from the adhesive tape on the bulb seal. See the images above to see where to position the seal in relation to the outside edge of the panel. Begin working the seal across the panel exposing small sections of the adhesive at a time. Carefully trim any excess material using a razor blade.



APPLY PRESSURE TO INSURE ADHESION

Before proceeding, use a cloth covered in Armor All® and wipe the exposed surface of the seal. This will allow the tools mentioned below to slide smoothly over the surface of the seal.

The adhesive used on the bulb seal is pressure sensitive. Finger pressure is not enough and will not properly transfer the adhesive to the panel. To insure a proper transfer, apply firm pressure using a roller wheel. Begin on one end and work across its length using a firm, even pressure.

Repeat several times from end to end over its entire surface area.

HARD FOLDING TONNEAU COVER INSTALLATION GUIDE



1
To open the cover lift the latch release handle and open the rear panel to the fully open position.



2
To insure proper operation of the center latch mechanism always open and fold the rear panel of the cover to its fully open position before starting any folding motion of the second or third panels.



3
Continue the opening sequence by folding the second and third panel to the fully open position.



4
With the cover in the fully open and stacked position secure all three docking straps. It is important to secure the docking straps at all times when the cover is in the fully open position.



5
To close the cover, reverse these steps in the same order, making sure to close the rear panel last.

Note: Only operate the vehicle with the cover in the closed and latched position or the fully open position with the docking straps securely fastened. Operation of the vehicle with the cover in partially opened positions can cause severe damage to the cover and possibly the vehicle.